

People
love

English Guide for Takenomaru

http://www.youtube.com/playlist?list=PLnQ6afouTd-lz1geNlqh7RsJiLSEM_xiv

Get it
for
info

Takenomaru is a WiFi free spot.

You can use your cellphone by scanning QR code to see videos of recommended spots at Takenomaru. Through WiFi connection, you can get to a video guide to enjoy Takenomarus beautiful views. ※Wifi requires a password, please ask staff for it.

1

Small paper sliding windows on sliding screen doors

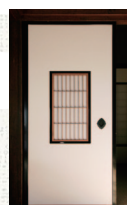

2

Variety of handles



3

Air vent of the ceiling



4

Ceiling of dirt floor (earth floor)

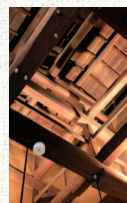

12

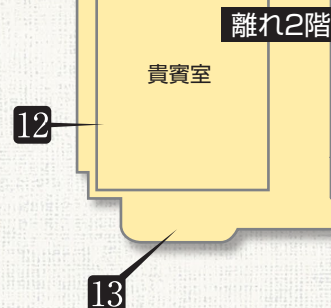

5

Open-able window shutters



7

To exhibit "chouna" shaving



8

Nekoma shouji and Yukima shouji (shouji - paper sliding door)



8

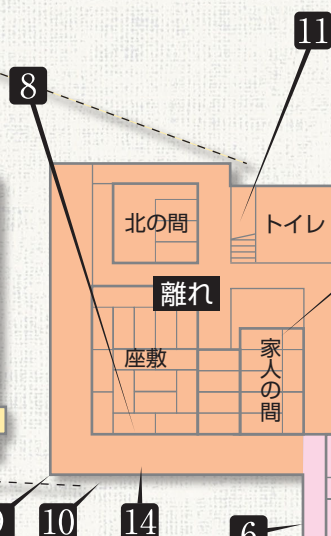

6

5

3

1

2

11

7

9

How do you put all these window shutters away?

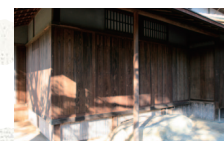

11

Why is stairway surprisingly bright?



10

Ditch next to the "inu bashiri"



12

The window which combines Japanese and Chinese styles of architecture



13

Why "No Entry" to the balcony?



14

Seeing space by a continuance

